



Painter 7™

Welcome to Painter 7™, the Natural-Media® painting application for fine artists, graphic designers, animators, Web site developers, and anyone interested in creating art using both traditional media and astounding new tools.

Create a brush library

Painter 7 provides a default brush library containing brush categories. Each brush category has a set of brush variants (types). Settings for a variant are saved in XML files. The library, categories and variants appear in the **Brushes** palette. The categories appear both as JPEG icons and as items in the menu list on the lower left. As you select categories, the variant items in the lower right menu list change to reflect the category chosen.

As you create artwork and modify brush variants to your tastes, you may want to save these variants and even the categories they belong to with their own descriptive names. You may want to save these all in your own library and use it as the default Painter 7 library.

In order to save customized brush variants into new category and library folders, these folders must be created in the **Brushes** folder where Painter 7 resides on your computer.

What you will learn

In this tutorial, you will learn how to

- create a brush library and category folder
- create a JPEG icon for the brush category drawer
- load a new library to the **Brushes** palette
- modify and save a brush variant
- set the new library as the Painter 7 default

Create a Brush Library and Category folder

1. In Apple Finder™ or Microsoft® Explorer, go to **Painter 7 ▶ Brushes** and create a folder called **My Brushes**.
2. In **Painter 7 ▶ Brushes ▶ Painter Brushes**, duplicate the **Airbrushes** category folder.

3. Drag the **Airbrushes** copy folder into the **My Brushes** folder, and rename it **Fingerprint**.

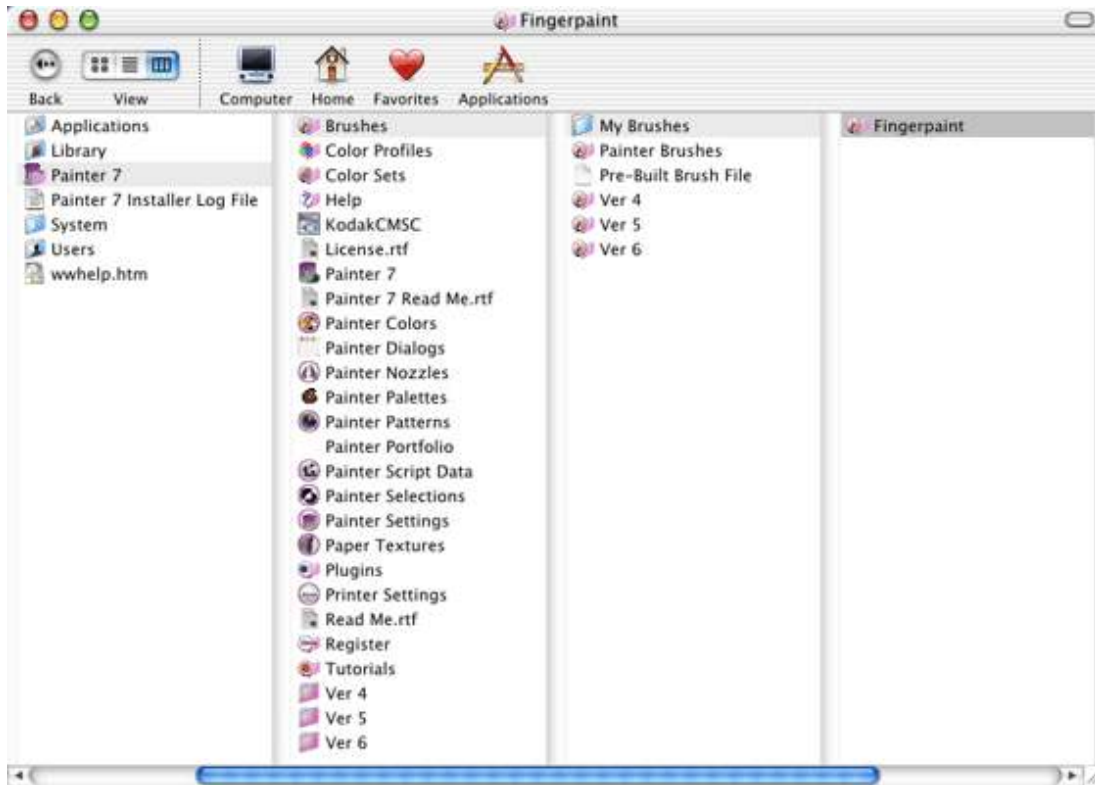

Now the folders and files are in place to customize and save new brush variants in. To add more brush libraries and their categories to the **Brushes** folder, repeat these procedures, using different names.

You can just as easily create your own folders, rather than copying and pasting them, but the actual XML files that constitute the brush variants must be generated by modifying and saving an existing variant.

Create an icon for the Fingerprint brush category

Painter 7 provides a JPEG icon for each category in the default **Painter Brushes** library. If you wish to have icons in the brushes palette for your own library's categories, this lesson covers some ways to create the icons.

You can do any of the following

- Create an icon by copying and modifying an existing one.
Continue with the tutorial steps below.
- Use the downloaded icon graphic.

This is what the graphic looks like:



If you used this sample icon, proceed to the next lesson of the tutorial.

- Create an icon from scratch.



The finished icon must be 30 x 30 pixels in size, 72 dpi, and saved to the JPEG format in the **My Brushes** library folder with the same name as the category folder it will represent.

If you created your own icon, proceed to the next lesson of the tutorial.

Copy the icon to the new folder

1. In the Apple Finder or Microsoft Explorer, go to **Painter 7 ▶ Brushes ▶ Painter Brushes**, duplicate the **Airbrushes.jpg** icon file, and drag the copy into **My Brushes**.
2. In **My Brushes**, rename the icon file **Fingerpaint.jpg**.

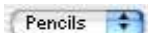
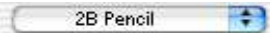
Modify the icon in Painter 7

1. In Painter 7, open **Fingerpaint.jpg**.
2. To fit in the **Brushes** palette and drawer, the file size is 30 x 30 pixels. The image window may open very small. With the mouse, drag the image window open wider to view the tools on the image frame.
3. Use the scale slider  on the image window's bottom border, and zoom in until there is enough room to work on the image.
4. From the popup menus at the bottom of the **Brushes** palette, select a brush category  and variant .
5. From the **Art Materials** palette's **Color** section, click and drag on the pickers in the **Hue** ring and the **Saturation/Value** triangle  to select a color.
6. From the **Brush Controls** palette's **Size** section, use the **Size** slider  to reduce the brush size to work on the zoomed image.
7. Edit the image.
8. Save and close the file.

Now all the necessary files, folders, and icons are in place to load the **My Brushes** library to the **Brushes** palette.

Load the My Brushes library to the Brushes palette

1. Open Painter 7.
2. In the **Brushes** palette, select **Load Library** from the brush category popup menu.



3. In the **Brush Libraries** dialog, select the **My Brushes** library and click **Load**.

In the **Brushes** palette, the title bar says Fingerpaint, the icon appears in the tray, the Fingerpaint category menu says Fingerpaint, and the copied airbrush variants are in the variant popup menu.

With the library loaded, you can start modifying and saving the brush variants.



Modify and save a brush variant

1. Open a new file in Painter 7 to test your modified brush in.
2. In the **Brushes** palette, select **Coarse Spray** from the **Fingerpaint** brush variant popup menu.



3. In the **Brush Controls** palette's various sections, adjust sliders, enable or disable options, and choose menu items to customize the variant.
4. In the **Brushes** palette's **Variant** popup menu, choose **Save Variant**.
5. In the **Save Variant** dialog, enter the name **Thumb**. Check the **Save Current Colors** option if you want the variant to use only the color it's now using. Click **OK**.

In this way, you can modify the XML files to create all new variants for each brush category in the **My Brushes** library.

If you want to delete the original variants after you've saved the new ones, select the original variant from the variant popup menu and choose **Delete Variant** in the **Variant** popup menu.

Setting My Brushes as the default library in Painter 7

1. In Painter 7, choose **Edit** menu ▶ **Preferences** ▶ **General**.
2. In the **General Preferences** dialog, type **My Brushes** in the **Brushes** field. Click **OK**.

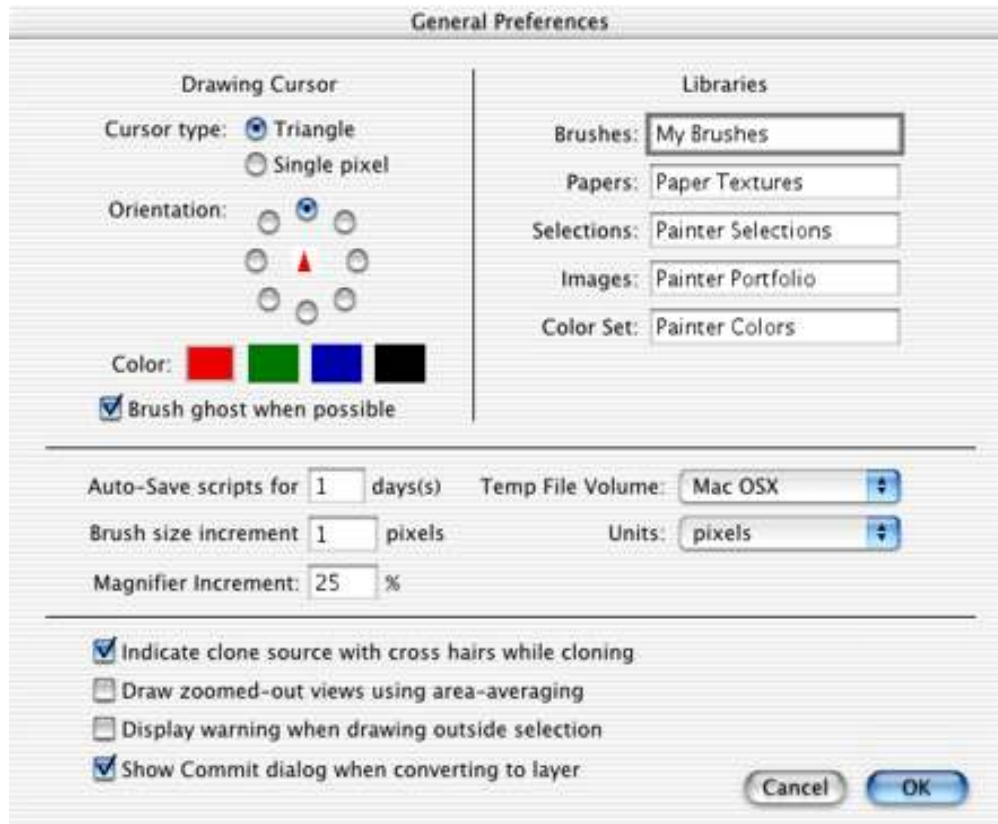

The next time you open Painter 7, the **My Brushes** library with the **Fingerpaint** category and **Thumb** variant will be in the **Brushes** palette.

From here . . .

Now that you have learned how to create a brush library, you can explore Painter 7 on your own or learn about other features by completing another tutorial.

For more information on the topics and tools presented in this tutorial, you can refer to the User Guide or the Help.

To access the Help, click **Help** menu ► **Help topics**.

For more information about

Brush libraries, categories, variants
 editing general preferences
 zooming in and out of images
 selecting colors
 adjusting brush size

In the Help Search field, type the following (and click Search)

brush
 preferences
 working with documents
 working with color
 setting size controls